



# The Power of Place:

Regional Higher Education Networks for Community Transformation

February 28-29, 2008 | University of Pennsylvania

**PHENND**

Philadelphia Higher Education Network for Neighborhood Development

**Welcome!** On behalf of the seven PHENND Co-Chairs, it is my great pleasure to welcome you to the 20th Anniversary Conference of the Philadelphia Higher Education Network for Neighborhood Development (PHENND).

When colleagues Bill Sullivan (La Salle University), James Hilty (Temple University), Maurice Eldridge (Swarthmore) and I created PHENND over 20 years ago, we could not imagine the impact this new consortium would have at our institutions and in our communities. The current breadth and depth of PHENND's work is truly remarkable, and is made possible only through the commitment of its member institutions.

Like other major cities, Philadelphia has a wide variety of colleges and universities – private, public, secular and faith-based, liberal arts and pre-professional. Each have their own unique mix of programs and partnerships but through PHENND, all are working together to build sustainable and meaningful partnerships with their local communities.

I could not be more optimistic about the potential of PHENND and other networks here today to serve as models for the rest of the country. In the midst of global change, these networks are focused on addressing global problems as they are manifested locally. Place matters. Moreover, no small measure of our success as institutions of higher education depends most upon embracing our place, and engaging in democratic partnerships that benefit our local communities and our universities.

Thank you again for making this event such a success! I look forward to another 20 years of collaboration.

*Ira Harkavy*

#### **PHENND Co-Chairs**

##### **Dr. Ira Harkavy**

Director  
Netter Center for Community  
Partnerships  
University of Pennsylvania

##### **Debra Kardon-Brown**

Lang Center for Civic and  
Social Responsibility  
Swarthmore College

##### **Dr. David Bartelt**

Professor  
Geography and Urban Studies  
Temple University

##### **Dr. Marcine Pickron-Davis**

Assistant to the President for  
Community Engagement and  
Diversity Initiatives  
Widener University

##### **Dr. Karen Tidmarsh**

Dean of the College  
Bryn Mawr College

##### **Dr. Frank Bernt**

Director, Faith-Justice Institute  
Saint Joseph's University

##### **Dr. Suzanne Rocheleau**

Associate Dean, Pennoni  
Honors College  
Drexel University

## Conference Theme And Key Sessions

This conference is a unique gathering of individuals and institutions from across the country exploring the impacts, histories, and methods of regional higher education networks focused on “community transformation.” We are happy to have attracted people involved in a wide variety of campus-community partnerships—service-learning, community service, education reform and community development.

This conference is intended to help campus leaders who have considered forming such a network with one or more neighboring institutions, as well as anyone already in the process of doing so. We believe that our field can be enhanced by working across communities—not just across institutions. By bringing together individuals involved in regional networks, or trying to form such networks, we hope to transform the landscapes of both higher education and local communities across the country.

Thursday's sessions will be about understanding regional networks. What are they? How do they function? In the morning, we will hear from representatives of existing networks—some are statewide (MA Campus Compact), some are multi-state (Midwest Consortium for Service-Learning in Higher Education) and some are metropolitan (Washington, DC's CoRAL Network). The afternoon panel will shift the focus slightly to discipline-based networks (though still with a strong sense of place). In particular, each of the speakers represents a network within the STEM fields (Science, Technology, Engineering and Math) demonstrating how faculty can work together across institutions, and yet within their own localities and fields of interest, to bring about change.

Friday's sessions will focus on the outcomes regional networks can have. The morning panel features one example of a network focused on addressing a specific community issue—poor schooling in the City of Chester. Six colleges and universities in Delaware County, Pennsylvania have joined together to form the Chester Higher Education Partnership. Three of those institutions' Presidents will tell us why they have formed such a network, what they gain from, and contribute to, this partnership, and what its impacts are in the community. Our conference will close with a final panel of some of the field's most important thinkers who will discuss the future role and impacts these networks can have. In 20 years, what will these networks look like? Will they even exist? What will the impacts be? on the campus? and in the community?

On both Thursday and Friday, workshops will be offered, covering diverse topics and themes such as how to start a regional network and funding opportunities for regional networks. The workshops are intended to be hands-on, and provide concrete details for how to implement “lessons learned” in your own backyard. Presentations from other regional networks will also be featured in the workshop setting.



## Our Mission

The Philadelphia Higher Education Network for Neighborhood Development (PHENND) is a consortium of over 40 colleges and universities in the greater Philadelphia area. PHENND works to build the capacity of its member institutions to develop mutually beneficial, sustained, and democratic community-based service-learning partnerships. The consortium actively seeks to revitalize local communities and schools and foster civic responsibility among the region's colleges and universities.

Higher educational institutions can function as permanent anchors and partners for community improvement. Moreover it is deeply in their interests to do so; their futures are intertwined with that of their neighborhoods. PHENND provides a vehicle for coordinating and, where appropriate, combining the efforts of higher eds so that they can make a significant contribution to improving the entire Philadelphia region.

## Our History

The Philadelphia Higher Education Network for Neighborhood Development (PHENND) began in 1987 with representatives from five colleges and universities. In the spring of 1991, interest in PHENND began to increase, witnessed by an organizational meeting that drew over twenty participants from higher educational institutions throughout the area. In 1992, PHENND co-sponsored and was the lead organization of Philadelphia's Summer of Service Project, part of an initial effort in President Clinton's National Service Program. The program, Immunize Children At-Risk Early (ICARE), involved the coordination of 12 higher educational institutions through PHENND, the City's Health Department, the Greater Philadelphia Urban Affairs Coalition, and the School District of Philadelphia, as well as other organizations. In 1993, PHENND began to hold regular meetings and policy workshops with local, state, and federal officials.

Metropolitan-area higher ed collaboration was strengthened in 1994 when several Philadelphia-area institutions received grants through Pennsylvania Campus Compact to develop a corps of part-time service scholars. Managing the only part-time corps in the nation, the Philadelphia program coordinators met regularly, helping solidify a regional approach to national service. The program was so successful it became a model for the current "Ed-only" AmeriCorps award, administered by the Corporation for National Service.

In 1997, PHENND received a major grant from the Corporation for National Service as part of the first round of higher education consortia awards under the Learn and Serve program. Since that time, PHENND has grown from an organization of five colleges and universities to over 40 and from 25 individuals to over 3,000.

Since 1997, PHENND has held an annual conference, which draws higher ed faculty, students, and administrators as well as representatives of community based organizations and public schools to discuss issues pertaining to campus-community partnership. Last year, PHENND's Eighth Annual Conference, which drew participants from Southeastern Pennsylvania and Southern New Jersey, focused on "Power, Access and Equity." Keynote speaker Congressman Chaka Fattah gave a provocative talk about persistent disparities in Philadelphia and the region, particularly with regard to the educational attainment of young people.

Currently, PHENND has embarked on a three-year program to "Institutionalize Service-Learning" at eight area higher eds. This program is supported by Learn and Serve America through the Pennsylvania/New York Campus Compact Consortium. PHENND is working with eight selected institutions to help them broaden and deepen their

service-learning programs, emphasizing improved faculty development and community partner development. In addition, PHENND provides training and technical assistance to a variety of university- and community-side practitioners on a wide variety of topics including student volunteer training, service-learning, community-based research, and the best practices of partnership. In addition to supporting the work of member institutions, PHENND also coordinates its own programs which bring the resources of the PHENND Network to bear on particular issues or problems. New initiatives over the years include the Food Stamp Enrollment Campaign, the Financial Outreach Initiative, and the Scholars in Service to Pennsylvania program.

PHENND's growth signals an increasing recognition that significant curricular and co-curricular benefits can result when student and faculty members focus their research on working with the community. Finally, the PHENND approach provides a way to more effectively educate students for citizenship by providing them with opportunities to serve.

PHENND provides increased hope that higher educational institutions will work together to help solve our country's most pressing problems. For the Philadelphia area, PHENND signals a new kind of democratic partnership that will result in substantial benefits for the colleges, universities, schools and communities of our region.

## Agenda at a Glance

### Thursday, February 28

(Bodek Lounge, Houston Hall)

- 9:00 AM Welcome
- 10:00 AM Panel: Profiles of Regional Networks
- 12:00 PM Lunch
- 1:30 PM Poster
- 2:00 PM Concurrent Workshops
- 3:30 PM Panel: Science, Technology, and Math Education Networks for Social and Economic Development
- 4:30 PM Poster Session
- 7:00 PM Gala Dinner with Mayor Michael Nutter, Woodlands Ballroom, Inn at Penn, 3600 Sansom Street

### Friday, February 29

(Terrace Room, Logan Hall)

- 9:00 AM Welcome
- 9:15 AM Panel: Mobilizing Networks for a Common Purpose:  
The Chester Higher Education Council
- 10:30 AM Concurrent Workshops
- 12:00 PM Lunch
- 1:15 PM Panel: The Next 20 Years: New Directions and  
Ongoing Challenges for Regional Networks

# Detailed Agenda

Thursday, February 28

9:00 AM

Opening and Welcome with Dr. Ira Harkavy, Netter Center for Community Partnerships, University of Pennsylvania

10:15 AM

Plenary Session: Profiles of Regional Networks featuring: Barbara Canyes, Massachusetts Campus Compact; Dr. Sarah Stiles, Community Research and Learning Network; Dr. Gary Heusel, Midwest Consortium for Service-Learning in Higher Education and Dr. David J. Maurrasse, President & CEO, Marga Incorporated; with moderator Amy Cohen, Learn and Serve America

11:45 AM

Break

12:00 PM

Lunch with Keynote Speaker Dr. Henry Louis Taylor, University at Buffalo: *Beyond Civil Rights and Liberal "Do Goodism": Recreating the Urban Metropolis*

1:30 PM

Poster Session

2:00 PM

Concurrent Workshops (see the following page)

3:30 PM

Plenary Panel: Science, Technology, and Math Education Networks for Social and Economic Development featuring: Dr. George Catalano, Engineering, Peace, Justice, and the Earth; Glenn Odenbrett, Collaborative Learning for Environmental Action Network, Dr. Lisa Marano, Math and Social Justice Network, with moderator Joe Bordogna, University of Pennsylvania and Greater Philadelphia Regional Compact for STEM Education

4:30 PM

Poster Session

7:00 PM

Gala Dinner with invited Keynote Speaker Mayor Michael Nutter

Friday, February 29

9:00 AM

Welcome - Craig Carnaroli, Executive Vice President, University of Pennsylvania

9:15 AM

Plenary Session: Mobilizing Networks for a Common Purpose: The Chester Higher Education Council featuring: President James Harris, Widener University; Chancellor Sophia Wisniewska, Penn State Brandywine; and President Rosalie Mirenda, Neumann College with moderator Marty Blank, Coalition for Community Schools

10:15 AM

Break

10:30 AM

Concurrent Workshops (see the following page)

12:00 PM

Lunch

1:15 PM

Plenary Session: The Next 20 Years: New Directions and Ongoing Challenges for Regional Networks featuring: Dr. Matt Hartley, University of Pennsylvania; Bobby Hackett, Bonner Foundation; Theresa Cusimano, Colorado Campus Compact with moderator Maureen Curley, President of Campus Compact

# Workshop Descriptions

Thursday, February 28

**Funding Opportunities: Learn and Serve and Office of University Partnerships  
(Amy Cohen, Learn and Serve and Kinnard Wright, Office of University Partnerships, HUD)**

**Location: Class of '47**

Please come to an interactive session on federal funding for community partnerships and service-learning with Kinnard Wright of HUD's Office of University Partnerships and Amy Cohen of Learn and Serve America. Kinnard and Amy will talk about the opportunities upcoming in their agencies and share insights into effective grant-writing.

**The Senior Project Initiative: Regional K-16 Collaboration presented by Hillary Aisenstein and Brad Leposa, PHENND and Michelle Grimley, School District of Philadelphia**

**Location: Irvine G16**

For many years, PHENND has partnered with the School District of Philadelphia, to help connect colleges and universities to local schools for all manner of programs and partnerships. Currently, PHENND is working with the District to partner 10 public high schools with colleges in the region to help implement a newly rigorous "Senior Project." College students serve as "academic coaches" to high school seniors as they choose a research topic, investigate it, write a paper, conduct fieldwork, and do an oral presentation. The presenters will share their lessons learned from the first year of collaboration and discuss more broadly how colleges and universities, particularly through a regional collaboration, can support education reform efforts of their local districts.

**The Worcester UniverCity Partnership: "We're All in This Thing Together...Most of the Time" presented by Armand Carriere, Worcester UniverCity Partnership**

**Location: Irvine G7**

The Worcester UniverCity Partnership (WUP) is a unique collaboration among the Colleges of Worcester Consortium, the City of Worcester, and the Worcester business community with the stated purpose of engaging more fully the resources of the colleges in the economic and social development of the City. As the WUP enters its third year of operation burgeoning strengths and inherent weaknesses are becoming manifest. Executive Director Armand Carriere will examine the development of this partnership in Worcester, Massachusetts, citing the advantages of being able to access the resources of multiple colleges but also addressing the challenges associated with aligning the mission, goals, and vision of three disparate sectors of the community.

**Learning to Dance: Forming Regional Networks presented by Dr. Charlene Gray, Executive Director, PA Campus Compact**

**Location: Irvine Amado Recital**

As colleges and universities renew their commitment to the public good and their institutional stewardship for surrounding communities, they may discover that they share community partnerships with neighboring institutions of higher education. Their institutional missions, faculty research and teaching interests, and student leadership core may align to enhance their community's quality of life. This workshop will identify promising practices and resources for forming regional networks that support service-learning, volunteerism and civic engagement.

# Workshop Descriptions

Friday, February 29

**The Carnegie Classification for Civic Engagement and Sustainability for Institutionalization of Service-Learning presented by Dr. Cathy Burack, NERCHE and Barbara Canyes, MA Campus Compact**

**Location: Irvine Amado Recital**

The Carnegie Foundation's voluntary Community Engagement Classification both allows institutions to achieve recognition as well as providing them with a tool that can inform a strategic, sustainable approach to community engagement. The framework used by the Community Engaged Classification provides a guide for institutions to develop and document their community engagement efforts. The framework is intentionally designed to support multiple definitions, diverse approaches, and institutionally-unique examples and data. This workshop will provide participants with a greater understanding of the Classification on Community Engagement, and will demonstrate how the institutions can use the Classification to advance their community engagement efforts.

**Learning To Dance: Lessons Learned from Established and Expanding Regional Networks in PA and NY by Kate Dantsin, Learn & Serve, Program Manager, Pennsylvania Campus Compact**

**Location: Irvine G7**

The Building on Our Strengths initiative, funded by Learn & Serve America, Pennsylvania Campus Compact and New York Campus Compact, has supported seven regional networks for service-learning. These networks include higher education institutions and community partners that are strengthening communities through their partnerships. Early findings from these established and expanding networks will be shared and discussed to include best practices and evaluation results from the Building on Our Strengths initiative.

**Communication: The Glue that Holds the Network Together presented by Hillary Aisenstein, PHENND and Dr. Suzanne Blanc**

**Location: Irvine Green Room (G1)**

So, what makes a network work? Borrowing from social network theory and community organizing, PHENND Director Hillary Aisenstein will share the methods and strategies PHENND uses to keep the network growing and thriving. These methods rely heavily on electronic and other forms of communication. PHENND's evaluator, Dr. Suzanne Blanc, will also discuss recent results of surveys and interviews of various PHENND members about how they use the network and for what purpose.

**Service, Learning, and Advocacy: A closer look at the Philadelphia Food Stamp Enrollment Campaign presented by Mary Summers, University of Pennsylvania; Dr. Judith Porter, Bryn Mawr College; and Karen Wilson, former Director of Greater Philadelphia Coalition Against Hunger**

**Location: Irvine G-16**

This presentation will explore a particular service activity (pre-screening individuals for food stamp eligibility) as a unique and beneficial compliment to three different courses at three institutions of higher education in the Philadelphia area. The advocacy dimensions of the work will be highlighted. This presentation will focus on the nature of this activity, how and why it was integrated into different courses, and what has been learned from the whole process. Each of the three faculty presenting are veteran practitioners of service-learning and each felt that this program provided one of the best experiences for students they had ever come across, particularly because of the program's ability to provide opportunities for students to become advocates, both for individuals and for systemic change.

**Building Local and Regional Networks of Higher Education Partnerships to Support University-Assisted Community Schools presented by: Joann Weeks, University of Pennsylvania; Pamela Pittman and Gaetane Jean-Marie, University of Oklahoma-Tulsa; Frank Coyne, University of Denver; and Marilyn Davis and Kiran Kitara, University of New Mexico**

**Location: Houston Hall, Griski Room**

This session will explore three models of university-assisted community schools developed in Tulsa, Albuquerque and Denver and a new southwest network that is forming to share lessons learned and advance local practice.





*Center for Urban Studies  
Department of Urban and  
Regional Planning  
School of Architecture and  
Planning  
University at Buffalo  
2007*

## Keynote Speaker

### Dr. Henry Louis Taylor, Jr

Professor Henry Louis Taylor, Jr., is an internationally known scholar and founding director of the University at Buffalo Center for Urban Studies (CENTER), a research, neighborhood planning, and community developing institute. He is also a full professor in the Department of Urban and Regional Planning in the School of Architecture and Planning at UB.

Taylor is the editor of three books and a monograph and is currently completing a book on neighborhood development in Havana, Cuba, between 1989 and the present. He has written more than 80 articles, book reviews, commentaries, and technical reports on urban and regional planning. Taylor has appeared on ABC Nightline, and he has been quoted in numerous national publications, including the *New York Times* and *Time Magazine*.

Professor Taylor has received numerous awards for his research and neighborhood planning activities. In 2001, along with Sam Cole, he won the Fannie Mae Foundation Award for the best practice base paper at the American Collegiate Schools of Planning Conference, and in 2005, he received the *Distinguished Leadership Professional Planner Award* from the American Planning Association, New York Upstate Chapter. Most recently, the Black Community Division of the American Planning Association gave him a Certificate of Appreciation for his work on the division Task Force on Hurricane Katrina, which is working with the New Orleans African American Community.

As an urban planner, Taylor participates in projects on brownfield redevelopment, economic development, and neighborhood planning and community development. In 2005, he received the prestigious HUD Community Outreach Partnership Grant to launch a community development project in the Fruit Belt and Martin Luther King, Jr. neighborhoods. He is directing a major community outreach component of a broader project on brownfield redevelopment with Urban Strategies, Inc., a Canadian based planning and architectural firm, and the City of Niagara Falls on a Brownfield Redevelopment project.

# Speaker Bios

## Dr. Ira Harkavy

*Netter Center for Community Partnerships, University of Pennsylvania*

Ira Harkavy is Associate Vice President and founding Director of the Barbara and Edward Netter Center for Community Partnerships, University of Pennsylvania. As such, Harkavy has helped pioneer service learning and academically-based community service courses as well as participatory action research projects that involve faculty and students from across the university. Dr. Harkavy has written and lectured widely on the history and current practice of urban university-community partnerships and strategies for integrating the university missions of teaching, research, and service. In addition to his action oriented work, Harkavy also teaches in the departments of history, urban studies, Africana studies, and city and regional planning.

## Barbara Canyes

*Massachusetts Campus Compact*

Barbara Canyes is the Executive Director of Massachusetts Campus Compact. In that role she provides overall leadership for the MACC (Mass. Campus Compact) which is a consortium of 75 college and university presidents committed to developing the civic engagement skills of students, building partnerships with the community, and integrating civic engagement with teaching and research. From 1987 to 2000, she taught and was an administrator of academic support centers at both large and small colleges. Ms. Canyes has also managed experiential learning centers and study abroad programs. She received her M.A. in Higher Education from the University of Maryland in College Park.

## Dr. Sarah Stiles

*Community Research and Learning Network*

Professor Stiles brings to the CoRAL Network a long history of incorporating service-learning into her classes. From 1999 until 2007 she taught in the School of Public Affairs at American University where for the last 6 years she was director of the Leadership Program. Students learned leadership skills through hands-on service-learning projects partnering with local CBOs. As Executive Director of the CoRAL Network in Washington, DC, Stiles helps facilitate communication among the member universities and local CBOs and encourage faculty development in service-learning and community-based research. The

CoRAL Network holds an annual conference in April showcasing these university/community partnerships. Currently Prof. Stiles is teaching social entrepreneurship at Georgetown University.

## Dr. Gary Heusel

*Midwest Consortium for Service-Learning in Higher Education*

Dr. Gary Heusel is director of the Midwest Consortium for Service-Learning in Higher Education with offices at the University of Nebraska Lincoln. His primary responsibility is to support the 26 institutions in Iowa, Nebraska and South Dakota that are members of the Consortium as faculty and staff integrate service-learning into their curricular and co-curricular programs to benefit students and communities. During the fall semester there were more than 1200 faculty members and 10,000 students engaged in service-learning at institutions that are members of this consortium.

Dr. Heusel earned his bachelors, masters and doctor of education degrees from the University of Illinois. He has been involved in higher education for 37 years. During his career he has worked with educators, community leaders and volunteers across the U.S. and in seven other countries. He spent 34 years working with community service-learning for K-12 service-learners involved in the 4-H program before joining the Consortium in 2004. He is professor emeritus of education and leadership at the University of Nebraska.

A staunch believer in experiential learning and a life long learner he describes himself as more scholarly practitioner than practicing scholar. He is a community volunteer for family, youth and church programs. He has been married to Karen for 32 years. They have a 30 year old son.

## Dr. David Maurrasse

*President, Marga, Inc.*

Dr. David Maurrasse is the President, CEO, and Founder of Marga Incorporated, a global consulting firm dedicated to forging and strengthening pathways to take on the great issues of the twenty-first century through cross-sector partnerships, philanthropy, strategy, and management. Marga serves as a partnership catalyst bringing together stakeholders across sectors and across national boundaries to address shared concerns. By strengthening common bonds, Marga has contributed to unlocking untapped potential in numerous localities

across the United States. Opportunities have also emerged for Marga to share its expertise and knowledge beyond the U.S., in countries such as Canada, Mexico, the U.K., and China.

In forging pathways toward a better future, Marga has worked with a number of foundations, including the Annie E. Casey Foundation, the Community Foundation for Greater New Haven, the Kellogg Foundation, the Ford Foundation, the Open Society Institute, the California Endowment, and the San Francisco Foundation. A range of strategic partnerships exist with corporate stakeholders such as CitiGroup, government entities such as the city of Atlanta, and institutions of higher learning such as Duke University, the University of Pennsylvania, Columbia University, London Southbank University (U.K.), Simon Fraser University (Canada), and Iberoamericana (Mexico).

Since 2000, Dr. Maurrasse has been on the faculty at Columbia University's School of International and Public Affairs. He is currently Associate Research Scholar in the School and a Strategic Advisor to the University's Earth Institute. At Columbia, he founded the Center for Innovation in Social Responsibility (CISR) which researched and promoted dialogue on the formation of partnerships involving corporations, higher education, philanthropy, and various other industries. The activities of CISR served to incubate the ideas that would eventually take form as Marga. Before moving to Columbia University, Dr. Maurrasse was a professor at Yale University from 1995-2000. From 1998-2000, he was a Senior Program Advisor at the Rockefeller Foundation, where he worked on community building and an initiative to further higher education/community partnerships.

A leading author, speaker, and researcher on the relationship between major institutions and their surrounding communities, Dr. Maurrasse has published important books in his fields of research all directed toward advancing new thinking about partnerships. In *Listening to Harlem: Gentrification, Community and Business* (2006), his latest, Dr. Maurrasse explores the opportunities and challenges of urban development as played out in Harlem between longtime community residents and newly established businesses. Growing out of Dr. Maurrasse's earlier work, *A Future for Everyone: Innovative Social Responsibility and Community Partnerships* (2004) which examines corporate and institutional pathways for contributing to society, *Listening to Harlem* delves deeper and presents ideas and recommendations for unleashing untapped resources in communities such as Harlem. In 2001, Dr. Maurrasse laid the groundwork for his ideas about the role of partnerships in changing society with *Beyond the Campus: How Colleges and Universities form Partnerships with Their Communities*. This work focuses on the ways that institutions of higher learning and their surrounding communities have worked together to pursue common goals.

Dr. Maurrasse has been a member of the board of several organizations. He currently serves on the Board of Bucknell University, Public Health Foundation Enterprises, and World Savvy, an organization started by two of his students focused on promoting global education in schools. He is also the current Chair of the Alliance for Community Enhancement (ACE) at Columbia University, a student-run nonprofit organization that partners with community based organizations in Harlem, funded by the Ford Foundation. Additionally, Dr. Maurrasse is a founding board member of the Association for Community and Higher Education Partnerships (ACHEP) and has served as Chair of the Board of Alliance for Nonprofit Management.

Dr. Maurrasse graduated from the University of Michigan. He received a Ph.D. in sociology from Northwestern University.

## Amy Cohen

### *Director, Learn and Serve America*

Amy Cohen is director of Learn and Serve America at the Corporation for National and Community Service. Prior to joining Learn and Serve America, Amy worked at the Center for Community Partnerships at the University of Pennsylvania. Cohen received her degrees from Brandeis University and the University of Pennsylvania. She currently resides in Falls Church, VA, with her daughter, Lia.

Learn and Serve America is the federal resource for service-learning in schools, community organizations, and higher education. Through over 1700 local programs across the nation, Learn and Serve involves over one million students in meeting community needs and solving problems with others in their communities. In performing service, students build their academic and civic skills. Learn and Serve America also administers the National Service-Learning Clearinghouse ([www.servicelearning.org](http://www.servicelearning.org)), the nation's source for service-learning information as well as the President's Higher Education Community Service Honor Roll.

## Dr. George Catalano

### *Binghamton University*

Dr. George D. Catalano is a Professor of Bioengineering and serves as Director of the Binghamton University Honors College. He earned a PhD from the University of Virginia in 1977 in aerospace engineering with emphasis in turbulence. He is author of three engineering books and one book on his life with Alaskan malamutes. He has authored over 100 technical publications and received approximately 1 million dollars in external funding.

## Glenn Odenbrett

### *Collaborative Learning for Environmental Action Network*

Glenn Clayton Odenbrett is a nationally-recognized leader in the area of integrating community service with undergraduate coursework, and regularly serves as either a coordinator or campus team facilitator for conferences and training institutes in this area. In 1998, Mr. Odenbrett organized and hosted a national institute on service learning in the Science, Engineering, and Mathematics (SEAMS) disciplines. In 2002, he led a faculty team that developed a plan for the institutionalization of service learning at Case Western Reserve University (Case). While leading the Case Office of Student Community Service for over a decade, he also established a community-based research program, directed a number of AmeriCorps National Service Programs, and enhanced institutionalization of service-learning through a faculty and curriculum development program established in partnership with the Office of Service Learning at Tulane University. In addition, he helped establish COOL City Cleveland, the first urban inter-institutional student-centered service network of the Campus Outreach Opportunity League.

Currently, Glenn is coordinator of CLEAN (Collaborative Learning for Environmental Action Network) at the Western Reserve Resource Conservation and Development Council (WRRCD), a Northeast Ohio umbrella organization affiliated with the Natural Resource Conservation Service of the U.S. Department of Agriculture representing the commissioners, planning organizations, and soil and water conservation districts of 9 counties. CLEAN is a coalition of Northeast Ohio faculty committed to preserving the region's environmental assets through engagement of undergraduate students in collaborative projects involving other higher education institutions and community-based partners such as the Cuyahoga Valley National Park and the Cuyahoga River Remedial Action Plan. Under Glenn's leadership, CLEAN has partnered with SENCER (Science Education for New Civic Engagements and Responsibilities), an NSF-funded curriculum development program linking the sciences with civic engagement at the undergraduate level. The current focus of CLEAN is promoting watershed stewardship in the Lake Erie basin of Northeast Ohio through service-learning and community-based research components of undergraduate science and engineering courses

## Dr. Lisa Marano

### *West Chester University*

Lisa Elaine Marano, Ph.D., is an Assistant Professor of Mathematics at West Chester University of PA where she is the coordinator for the B.S. in Applied Mathematics program. She also serves as Vice-President of the Eastern Pennsylvania and Delaware section of the Mathematical Association of America. Her primary research interests include probability theory and mathematical finance. She is currently involved with a group

of mathematicians to develop teaching materials which illustrate a variety of social justice issues quantitatively. She participated in two national workshops, Mathematics for Social Justice I and II, where her and her colleagues worked in small groups, each focusing on a different social justice issue, to develop teaching modules.

## Dr. Joseph Bordogna

### *University of Pennsylvania*

Joseph Bordogna is Alfred Fittler Moore Professor of Engineering at the University of Pennsylvania where he served also as Director of The Moore School of Electrical Engineering, Dean of the School of Engineering and Applied Science, and Faculty Master of Stouffer College House. His career includes experience as a line officer in the U.S. Navy, an engineer in industry, and a public servant in the federal government. He was a founder of PRIME (Philadelphia Regional Introduction for Minorities to Engineering) and serves on the Philadelphia Math and Science Coalition (regional community organizations providing supportive learning programs for K-12 students and teachers).

From 1991 to 2005, he served at the National Science Foundation (NSF), first as head of the Directorate for Engineering, then appointed by the President as Deputy Director and Chief Operating Officer of the Foundation. Complementary to these tasks he was a member of the President's Management Council and chaired committees on Manufacturing, Environmental Technologies, and Automotive Technologies in the President's National Science and Technology Council (NSTC).

He has made contributions to the engineering profession in a variety of areas including optical and radio communications, electro-optic recording materials, holographic video playback systems, educational innovation, management of technological innovation, and was awarded a commendation as Operations Officer of the Flagship of the naval unit which achieved the world's first space capsule recovery.

He is a Fellow of the Institute of Electrical and Electronics Engineers (IEEE), the American Association for the Advancement of Science (AAAS), the American Society for Engineering Education (ASEE), the International Engineering Consortium (IEC), and the Association for Women in Science (AWIS). He is a recipient of the George Westinghouse Award of ASEE for outstanding contributions to engineering education, Penn's Lindback Award for distinguished teaching, and was named to the Hall of Fame of Engineering Educators in 1993. He received the Gold Medal of the Society of Manufacturing Engineers in 2001 for published literature and formulation of national policy and the Semiconductor Industry Association Leadership Award

in 2004 for efforts to ensure a healthy and competitive semiconductor industry. Recently, he was awarded the NSF Distinguished Service Medal; elected Eminent Member of Eta Kappa Nu, the Electrical Engineering Honor Society; and received the American Society of Mechanical Engineers/Johnson & Johnson Medal for significant contributions to promoting diversity and inclusiveness in engineering. In 2005 a plateau in Antarctica was named Bordogna Plateau in recognition of his NSF Antarctic activities.

He holds B.S.E.E. and Ph.D. degrees from the University of Pennsylvania, the S.M. degree from the Massachusetts Institute of Technology, and six honorary doctorate degrees in engineering, science, and humanities. During 1998, he served his profession as global President of the Institute of Electrical and Electronics Engineers (IEEE).

Note: NSF speeches archived at <http://www.nsf.gov/bordogna>.

## President James T. Harris III

### *Widener University*

Dr. James T. Harris III became the ninth president of Widener University in 2002. Prior to his arrival at Widener, Dr. Harris served eight years as president of Defiance College. During his highly successful tenure, the college developed several innovative initiatives, including the Presidential Service-Leader Scholarship Program: The McMaster School for the Advancement of Humanity and, according to U.S. News and World Report, national recognition as one of the top service-learning schools in the country. For his dedicated leadership and service to Defiance College, the faculty and trustees unanimously voted to award him *The Pilgrim Award*, the college's highest honor.

During Dr. Harris' tenure as president, Widener has achieved record levels of private and governmental support and attracted the largest freshman class in the school's history. In fall 2006 and 2007, *Washington Monthly* magazine ranked Widener as one of the top 250 universities in the country that do the most for our nation. Widener ranked 47th placing it among the top 25 private universities in the United States. The school has also improved its physical plant through the development and implementation of a new master plan for the main campus that includes 50,000 square feet of new science and engineering space, renovated dining hall and dormitories, a new apartment style residence hall, and a new Wellness Center. In summer 2007, ground was broken for a \$50 Million Providence Avenue Revitalization Project.

Dr. Harris has been an advocate for enhancing Widener's reputation as a "student-centered" learning community. He regularly holds public town hall meetings and meets with students in small groups on a regular basis to seek input on how to improve the university's learning environment. He

frequently works along side students on community service projects and participates in the university's alternative spring break. In 2006, Dr. Harris accompanied a group of Widener students to Bolivia to renovate a school in an impoverished rural community.

Once a year he trades places with a student who becomes "President for the Day", while Dr. Harris fulfills the student's campus responsibilities, including attending classes. Dr. and Mrs. Harris host hundreds of students at their home every year. In addition, he continues to be a guest lecturer in various classes at Widener and has taught an honors leadership course in the School of Business Administration.

Dr. Harris has been asked to serve in several local, state and national leadership roles. A few examples of his responsibilities beyond Widener include membership on the board of directors of the National Association of Independent Colleges and Universities, the executive committee of the Coalition of Urban and Metropolitan Universities, and chair of the Middle Atlantic Conference Board of Directors. In 2007, Dr. Harris was named to the President's Council of The National Collegiate Athletic Association. Earlier in his career he served on a national commission for the advancement of service-learning established by President Clinton and since 2002, he has been a member of the faculty of the Management Development Program at Harvard University.

In recognition of his considerable contributions to education and the communities he has served, Dr. Harris has been the recipient of many awards and honors. Two examples include being named one of the top fifty character building university presidents in the United States by the John Templeton Foundation as well as being awarded the highest honor from the Northwest Ohio Chapter of the NAACP for his commitment to civil rights and social justice issues. In 2007, he was recognized as *Citizen of the Year* by the Delaware County Chamber of Commerce in recognition of the university's contributions to the local communities.

Dr. Harris has earned degrees from the University of Toledo, Edinboro University of Pennsylvania, and The Pennsylvania State University. All three of his alma maters have recognized Dr. Harris as a distinguished alumni including Penn State that bestowed upon him the lifetime title of Alumni Fellow. He has published widely and is frequently asked to speak about the importance of civic engagement.

Dr. Harris has been married to his wife and best friend, Mary, for twenty-six years and they are the proud parents of two sons, Zachary and Braden

## Chancellor Sophia Wisniewska

### *Penn State Brandywine*

Dr. Sophia T. Wisniewska has been Chancellor at Penn State Delaware

County since July 2005, serving as the third executive director in the campus' history. As Chancellor, Dr. Wisniewska oversees the academic, administrative and external arenas at the Delaware County campus, including curriculum and instruction; recruitment and development of faculty, staff and students; administrative and fiscal operations; community, alumni and government relations; and relations with individuals and institutions supporting the campus.

In her role as Chancellor, Dr. Wisniewska has forged partnerships with local institutions, including the Chamber of Commerce, the Middletown Business Association and Rotary of America. She has revamped the Campus Advisory Board to include a more representative group and to engage increased corporate and philanthropic leadership. Under her direction, a new campus entrance was constructed, financed in part with private funds that she successfully secured.

She has recruited 15 new faculty and staff, and has improved the credentials of the entering freshman class, raising entrance requirements while increasing overall enrollment.

Dr. Wisniewska came to Penn State Delaware County from Temple University's Ambler campus, where she served for five years as dean and campus executive officer. Prior to her service at Temple, she spent 21 years at Penn State University, with positions in the Commonwealth College and at the Great Valley, Abington and Berks campuses. In addition to these positions, she also served as an Administrative Fellow at the University in 1996-97. Dr. Wisniewska earned a bachelor's degree with honors from Penn State. She has a master's degree and a Ph.D. from Bryn Mawr College. She also attended Harvard University's Institute for Management and Leadership in Education.

She is the author of more than two dozen scholarly articles and conference presentations, and holds numerous academic and community honors and awards. She serves on the boards of the Delaware County Chamber of Commerce, the Workforce Investment Board of Delaware County, Riddle Village, New Horizons Montessori School and the Montgomery County Lands Trust.

## President Rosalie Mirenda

### *Neumann College*

Dr. Mirenda is committed to the Catholic Franciscan mission of the College, which is based on the belief that knowledge, while valuable in itself, is best used in the service of others. During the ten years of Rosalie Mirenda's presidency, Neumann College has made significant strides and expanded its positive impact on the region. Since she took the helm of the College in the fall of 1996, the number of full-time students has more than doubled, annual and capital giving has increased by more than 30%,

campus technology has been strengthened, team sports have moved from eight to seventeen, five buildings have been added, and new graduate and undergraduate programs have emerged.

## Martin J. Blank

### *Coalition for Community Schools*

Martin J. Blank is the Director for School, Family and Community Connections at the Institute for Educational Leadership. In that capacity, Marty serves as the Staff Director for the Coalition for Community Schools. The Coalition brings together leaders and networks in education, family support, youth development community development, government and philanthropy behind a shared vision of community schools. Community schools work to improve student learning and development, strengthen families and build stronger communities.

He led the preparation of Learning Together, a comprehensive map of the revitalized community schools movement across the country. In addition Marty is the co-author of Together We Can: A Guide for Crafting a Pro-family System of Education and Human Services and What It Takes: Structuring Interagency Partnerships for Comprehensive Services, which helped to fuel school and community partnerships in the past decade.

He provides technical assistance to local communities on school and community relationships, working particularly through national alliances such as the United Way of America and the Public Education Network. In Washington, DC, Marty is serves on the Executive Committee of D.C. VOICE a citizen-driven education reform collaborative, and Chair of the management team of the Early Childhood Collaborative.

He has a B.A. from Columbia University, 1965, and a J.D. from Georgetown University Law Center. He served as a VISTA Volunteer from 1965-67 in the Missouri Bootheel. His wife is the Director of Child Care and Development at the Children's Defense Fund. He has two daughters, Liza, 29 and Molly, 26.

## Dr. Matt Hartley

### *Assistant Professor, Graduate School of Education, University of Pennsylvania*

Matt Hartley teaches at the University of Pennsylvania's Graduate School of Education. His research and writing focus on academic governance and organizational change at colleges and universities. He is especially interested in exploring how institutional mission influences new programs and policies. His current research examines how American postsecondary institutions have attempted to advance a particular academic purpose—civic engagement. Dr. Hartley's recent publications include (with Christopher Morphew) Mission statements:

A thematic analysis of rhetoric across institutional type, *The Journal of Higher Education*, 2006; (with Ira Harkavy and Lee Benson) Building Franklin's truly democratic, engaged university: Twenty Years of Practice at the University of Pennsylvania. *Metropolitan University*, 2006; (with Elizabeth Hollander); and (with Lawrence Schall), "An endless good argument: An analysis of the adaptation of institutional mission at two liberal arts colleges and implications for decision making" in *Planning in Higher Education*, 2005. A book based on his dissertation research: *A Call to Purpose: Mission Centered Change at Three Liberal Arts Colleges* was published in 2002.

Dr. Hartley earned an Ed.M and Ed.D. from Harvard University's Graduate School of Education. Prior to his work at the University of Pennsylvania, he was an instructor for Hobart and William Smith Colleges as well as a teaching fellow and research assistant at Harvard University. He also served as co-chair of the editorial board for the Harvard Educational Review.

## Bobby Hackett

### *Bonner Foundation*

Mr. Hackett joined the Bonner Foundation in 1992 as Vice President and Director of the Bonner Scholars Program. He also directs the National Higher Education Community Based Research Project, which has received funding from the Corporation for National Service.

Prior to joining the Bonner Foundation, Mr. Hackett worked at the Telesis Corporation, an affordable housing developer in Washington, D.C. He also served as managing director of the Campus Outreach Opportunity League (COOL) during its first three years of operation. In addition, for the past twenty years, Mr. Hackett has been associated in various capacities with the Youth Policy Institute, a Washington, D.C.-based non-partisan organization that researches and reports on policies and programs relating to young people.

Mr. Hackett received his bachelors degree from Harvard University in 1985 and a masters in public and private management from Yale University's School of Organization and Management in 1990.

## Theresa Cusimano

### *Colorado Campus Compact*

Theresa Marie Cusimano is the Executive Director of Colorado Campus Compact and leads the higher education consortium known as the Intermountain West ~ Four Corners/Four States. Dr. Cusimano is a Juris Doctorate of Law and Public Education Policy from the State

University of New York at Buffalo where she led the Buffalo Public Interest Law Program, funding law students' work in public interest and nonprofit legal settings. Cusimano received her Master's degree in Higher Education Administration from Cardinal Strich College while she was the Assistant Dean of Students there for five years, heading up the service-learning program within both new student orientation and Freshmen Seminar course redesign.

Dr. Cusimano is a passionate advocate for education and worked as a policy analyst for the Western Interstate Commission for Higher Education, legal counsel for the U.S. Department of Education, legal counsel and advocate for the U.S. Catholic Conference of Bishops and the State University of New York's Education Opportunity Program.

Dr. Cusimano believes that education is the pathway through which access, economic development, and community sustainability are possible.

## Maureen Curley

### *President of Campus Compact*

Maureen F. Curley is president of Campus Compact, a national coalition of more than 1,100 college and university presidents dedicated to advancing campus-based service, service-learning, and civic engagement.

She has more than 25 years of experience in the nonprofit sector, concentrating in the areas of community service and public policy.

Among other leadership positions, Curley has served as Director of Public Policy for the Community Service Society of New York and as Executive Director of the Massachusetts Service Alliance, where she oversaw distribution of \$12 million in grants to support AmeriCorps community service-learning and mentoring programs. She also founded the Forum for Women Leaders of Nonprofit Organizations. Most recently she was the Chief Relationship Officer for Bridgestar, where she developed services to connect executive-level managers with career and board opportunities in the nonprofit sector.

Curley has taught courses on nonprofit and volunteer management at Columbia University, New York University, and UMass-Boston. Currently she serves on the board of directors of the National Service-Learning Partnership and Friends of the Children - Boston. Curley holds a B.A. in political science from Emmanuel College and a master's in human services administration from Antioch University New England.

# Workshop Presenters

## Dr. Cathy Burack

*Senior Research Associate, Higher Education, Center for Youth and Communities, Heller School for Social Policy and Management, Brandeis University.*

Prior to coming to Brandeis, Cathy was the Associate Director of the New England Resource Center for Higher Education (NERCHE), where she continues her affiliation as a Senior Associate.

For the past fifteen years Cathy has focused on ways faculty, students and administrators can work together to fulfill the civic missions of their colleges and universities. This has taken several forms including facilitating Think Tanks for senior campus administrators, co-coordinating and facilitating Wingspread meetings focused on the civic mission of research universities, directing various funded projects including Project Engage, a mini-grants program that supported student, faculty and community research teams working together on a community defined problem, a national evaluation of institutional support for service-learning, and extensive work with faculty from a wide variety of institutions.

She is also a member of the National Review Board for the Scholarship of Engagement, a Campus Compact Engaged Scholar, and a member of the Advisory Board for the UMass Amherst Masters track in Service-Learning and Engagement. She started and facilitated the NERCHE Multicultural Affairs Directors Think Tank for directors at colleges and universities throughout New England, and directed "Reversing the Telescope: Community Development from Within" which focused on the civic microcosm within the university community. She also serves on the Steering Committee of the Boston City Wide

Dialogues on Race project.

Cathy holds a Bachelors degree in Psychology from the University of Rochester, and a Doctorate in Administration, Planning and Social Policy from Harvard University. Cathy's work is under-girded by her core beliefs in the power of reflective practice, collaboration, importance of creating learning organizations, capacity building, and development of communities and the individuals who inhabit them.

## Kate Dantsin

Kate Dantsin is the Project Manager for the PA/NY Campus Compact Consortium Learn & Serve initiative. Her role includes providing training and technical assistance in collaboration, evaluation, service-learning and campus-community partnerships to ten sub grantees in PA and NY. She brings to this role experience as a community mobilizer and youth asset builder, as well as several years working in higher education with students and faculty. She is currently pursuing a master's degree in educational leadership at Lehigh University.

## Kinnard Wright

Kinnard Wright, Grants Specialist at the U.S. Department of Housing and Urban Development's Office of University Partnerships has over 20 years of experience in community development, human services and higher education. He holds a Masters Degree in Public Administration from Atlanta University and has served as Resource Development Officer at the Lutheran Resources Commission (a grants consultation organization) Foundation Fellow with the Council on Foundations, Vice President of Development at the Lutheran Social Services of the National Capital Area, and Development and Foundation Director at Prince George's Community College. In

addition to his professional positions, he has served on numerous non-profit and civic boards and commissions. Most recently, Mr. Wright was Chairman of the Board of Directors and Interim President of the Prince George's County Community Development Corporation, prior to joining the staff of the Office of University Partnerships. In addition to his duties at the U.S. Department of Housing and Urban Development, Mr. Wright is an Adjunct Professor in Public Administration at Southeastern University.

## Armand Carreire

Armand Carriere is the founding Executive Director of the Worcester UniverCity Partnership, a unique collaboration among the Colleges of Worcester Consortium, the City of Worcester, MA, and the local Worcester Regional Chamber of Commerce and Worcester Business Development Corporation. The purpose of this collaboration is to engage the colleges and universities of the area more actively in the general development of the City of Worcester.

Prior to coming to Worcester Mr. Carriere served as the Associate Deputy Assistant Secretary for University Partnerships at the U.S. Department of Housing and Urban Development (HUD) in Washington, DC. The Office of University Partnerships (OUP) is HUD's primary vehicle to encourage and expand the efforts of colleges and universities that are striving to make a difference in their communities.

A native of Woonsocket, RI, Mr. Carriere has a B.S. in Business Administration from the University of Rhode Island and a M.A. in Student Personnel Work from Ohio State University. He lives in Worcester with his bride of 34 years.



## Hillary Aisenstein

Hillary Aisenstein is the Director for the Philadelphia Higher Education Network for Neighborhood Development (PHENND). PHENND is a consortium of 40 institutions of higher education in the Greater Philadelphia region that seeks to help campuses connect to their communities through mutually beneficial service and service-learning partnerships. Since Ms. Aisenstein joined PHENND in 1999, the organization has increased its membership, developed new multi-university programs and partnerships, and become a leader in the field of service-learning.

Ms. Aisenstein is a graduate of the University of Pennsylvania where she received a Bachelor of Arts in Urban Studies. Ms. Aisenstein serves as President of the Executive Board of the Penn State Cooperative Extension for Philadelphia County. She is also on the Local Advisory Board of National Student Partnerships.

## Michelle Grimley

Michelle Grimley, LSW is currently the Program Manager of Character Education for the School District of Philadelphia. Ms. Grimley is committed to service learning and character education with more than ten of Philadelphia. Ms. Grimley is committed to service learning and character education with more than ten years of experience in a variety of roles and settings. As Program Manager, she coordinates the District's current Partnerships in Character Education grant (2002-2006), and leads in the design, delivery and implementation of service learning and character education throughout the District. Ms. Grimley's responsibilities also include assisting school-based staff with program implementation and curriculum integration, providing professional development, developing partnerships with local business and non-profits, and working with her colleagues throughout the District to streamline coordination of service learning implementation in the District. She received her Bachelor of Arts degree in Sociology/ Social Psychology and Education from Lehigh

University and a Master's degree in Social Work and Social Research from Bryn Mawr College.

## Dr. Charlene Gray

Char Gray is the executive director for PA Campus Compact, an affiliate with national Campus Compact whose purpose is to support campus-based civic engagement, service-learning and community service in higher education. Seventy two colleges and universities in Pennsylvania are members of Campus Compact. Her role is to provide support, training, and resources to these member institutions as students and faculty identify ways to partner with their communities to enhance the quality of life.

Previously, Dr. Gray served as Director of the Landis Community Outreach Center at Lafayette College. Her role as the director was to articulate vision, develop and empower student staff for outreach to the community through volunteer programs, provide resources and support for service-learning, and strengthen linkages between the college and the community. She holds a PhD from Vanderbilt University in Education and Human Development where her research focused on adult problem solving skill development. She taught and developed two service-learning courses in the college writing program at Lafayette. While at Vanderbilt, she assisted Dr. Janet Eyler and Dr. Dwight Giles on a FIPSE grant that examined the impact of service-learning on social, personal, civic, and learning outcomes. In conjunction with them, she compiled an annotated bibliography of the service learning research from 1993-2000 entitled "Research At a Glance" published by Campus Compact.

Prior to her doctoral work, Dr. Gray served as a leadership consultant for a non-profit, faith-based organization which involved designing customized curriculum for youth and young adults. She received an Master of Divinity degree from Southwestern Seminary and a BS from the University of Tennessee in Community Nutrition.

## Dr. Suzanne Blanc

Suzanne (Sukey) Blanc, Ph.D., is an educational anthropologist and the founder and principal consultant of Creative Research and Evaluation Services (CRES). Over the past 20 years, Sukey's work has centered on formative evaluation and participatory research in urban schools and communities. In her projects, Sukey works with clients and partners to identify the unique research questions, data, and activities that explore and document the strengths of the organizations with which she works. Based on fifteen years of close collaboration with colleagues at Research for Action, a Philadelphia-based nonprofit, Sukey has learned that students, teachers, and others involved with urban schools and communities have deep and well-founded insights about the strengths, as well as the challenges of their work. Her recent writing includes a reflective article about applied anthropology and several co-authored articles about school privatization in Philadelphia.

## Mary Summers

Mary Summers is a Senior Fellow in the Robert A. Fox Leadership Program and a lecturer in Political Science at the University of Pennsylvania. She teaches academically based community service seminars on the Politics of Food and Agriculture, the Politics of Poverty and Opportunity and Healthy Schools: Community Based Participatory Research, Planning and Action. She directs speakers' programs and service-learning projects in association with these courses. She was the principal investigator for a three-year grant from the USDA to the Greater Philadelphia Coalition Against Hunger that established the Food Stamp Enrollment Campaign. She has published articles in *Urban Affairs Quarterly*, *PS: Political Science and Politics*, *Agricultural History*, *The Nation* and several edited volumes.

## Dr. Judith Porter

Judith R. Porter is a professor of Sociology at Bryn Mawr College. Her research interests focus on the sociology of AIDS and injection drug use. She is currently working on a study funded by the National Institute of Drug Abuse on the role of needle-exchange programs as a bridge to service acquisition. She has authored multiple research studies presented at International Conferences on AIDS. She is the author of *Black Child, White Child: the Development of Racial Attitudes*. She has published articles in *Journal of Drug Use and Misuse*, *Contemporary Drug Problems*, *Medical Anthropology*, *Teaching Sociology*, *Annual Review of Sociology*, *Journal of Health and Social Behavior*, *Hispanic Journal of Behavioral Sciences*, *Journal of the American Academy of Dermatology*, *Revue Internationale de Psychologie Sociale*, *Sociological Forum* among other journals.

## Karen Wilson

Karen Wilson is the former director of the Greater Philadelphia Coalition Against Hunger, a non-profit organization that fights hunger through education, outreach and advocacy. Karen recently retired as founding director. Under her leadership the organization received the USDA food stamp research and outreach grant that originally funded the Philadelphia Food Stamp Enrollment Campaign. She raised the ongoing resources that have been needed to keep the Campaign running past the initial infusion of USDA money. Karen received her BS from the University of Delaware and a Masters in Management and Supervision from Central Michigan University. She is a registered dietitian. Her interesting career has spanned sales and management in the medical pharmaceutical industry to graduate teaching in health education to directing a non-profit for 12 years. Karen will discuss the Food Stamp Enrollment Campaign from the perspective of a non-profit.

## Joann Weeks

Joann Weeks is an associate director of the Netter Center for Community Partnerships at the University of Pennsylvania. Ms. Weeks directs national and international programs, including the national adaptation of the Netter Center's university-assisted community school model. Ms. Weeks is the associate editor of *Universities and Community Schools*, published by Penn.

## Pam Pittman

Pamela Pittman is Director of OU CORE – Center for Outreach, Research and Education at the University of Oklahoma-Tulsa. As a licensed Registered Nurse, her career dealing with trauma-related situations shifted Pam's focus to effectiveness of social service agencies and non-profit evaluations. She has spent over 12 years consulting for community profits/non-profits on Board development, leadership and training, chairing committees and Boards, program development and evaluation, needs assessments, strategic planning and sustainability-driven fundraising. She received the Charles B. Schusterman Award for Academic Excellence after completing her Master's in HR Applied Behavioral Research degree. Her growing University of Oklahoma-Tulsa initiatives and research continue to center on educational and social capital development, directing interdisciplinary and service-learning projects, creating action-oriented organizational infrastructure models of communication and group process, and identifying key and strategic components required for successful university/community collaborations. Recently, Pam organized a state regional multi-university coalition, The Metro Tulsa Champions of Education, involving task forces for Early Childhood Education, Workforce Readiness, Community Schools and multi-university Research Consortium; Co-Chairing the Advisory Board with Mayor Kathy Taylor comprised of K-12 Tulsa County District Superintendents, regional university Presidents and local foundations.

## Frank Coyne

Frank began as the Community Coordinator of the DU/Northwestside partnership in September of 2000 and is glad to be a part of the many exciting projects within DU's Center for Community Engagement and Service Learning. Seven years later, as Associate Director, Frank oversees the dynamic partnerships that DU has created with a host of K-12 schools throughout the Denver area. Frank's key role in this initiative is to pair the resources of DU (students and faculty) with the assets of schools in order to bolster the civic engagement of the K-12 students as well as the students from DU.

In addition Frank works to oversee service-learning faculty development on campus at DU and works to improve the relationship with dozens of community partners. Frank has presented at several major conferences around the country on the role of higher education in civic education. He also completed his graduate degree with a Secondary Teacher's Certification and Masters in Curriculum and Instruction in the College of Education at DU.

## Gaetane Jean-Marie

Gaetane Jean-Marie is Associate Professor of educational leadership in the Department of Educational Leadership and Policy Studies. She has a former background in pre-college programs and preparation of pre-service teachers of North Carolina Teaching Fellows. Her research interests include women and educational leadership, urban school reform, and educational equity. She has presented at local, regional and international conferences, conducted keynote addresses, and facilitated in-service training and workshops for school faculties on school improvement. Her recent work has been published in the *Journal of Educational Administration*, *International Electronic Journal for Leadership in Learning*, *Journal of School Leadership* (in press), and *The Educational Forum* (in press), among other refereed academic journals. She was a contributor to *Urban education: An encyclo-*

pedia (2005, Greenwood) and has a forthcoming chapter in *Triumphs and troubles: Historical and contemporary essays on Black colleges* (Palgrave Macmillan). Gaetane received her Ph.D. degree from the University of North Carolina at Greensboro, and masters and bachelor degrees from Rutgers, The State University.

## Marilyn Davis

Ms. Davis is responsible for identifying and designing mutually beneficial partnerships and opportunities for UNM undergraduate courses to connect theory with practice in New Mexico Rural and Urban communities through the UNM Research Service Learning Program. She is an eighteen year education administrator and part-time instructor of the University of New Mexico, with extensive expertise in the development, implementation and facilitation of school/university collaborations and partnerships. In addition, she brings 19 years of private sector corporate, legal, and entrepreneurial experience to higher education program development.

Previous higher education service includes: Montclair State University (MSU) as the Director of the New Jersey Consortium for Urban Education (NJCUE), a state department of education, higher education and urban school districts partnership; Director of the Montclair State University Urban Teaching Academy undergraduate program and; Adjunct Faculty member in the MSU Family Studies Department (Inner City Families).

Ms. Davis' doctoral major is quantitative research in the UNM Educational Psychology program. Her interests are two-fold: institutional research and mixed methods research related to higher education's commitment to school/community development. Specifically, she is interested in how universities, schools, and community organizations use data to inform their practice and their capacity to collaborate across institutions and non-profit agencies.

## Kiran Kitara

Kiran Katira is an East-African Indian. She received her Bachelors in Elementary Education/Multicultural Education in England and taught in a multiracial urban elementary school. She has a Masters in Educational Administration from New Mexico State University and a Ph.D. in Educational Thought and Socio-Cultural Studies from the University of New Mexico. For the past nine years, she has worked in a community-schools project in inner city Albuquerque. Her research interests and courses focus on race relations and education, community-based learning, and critical multicultural education.



# Perelman Quad Area Map

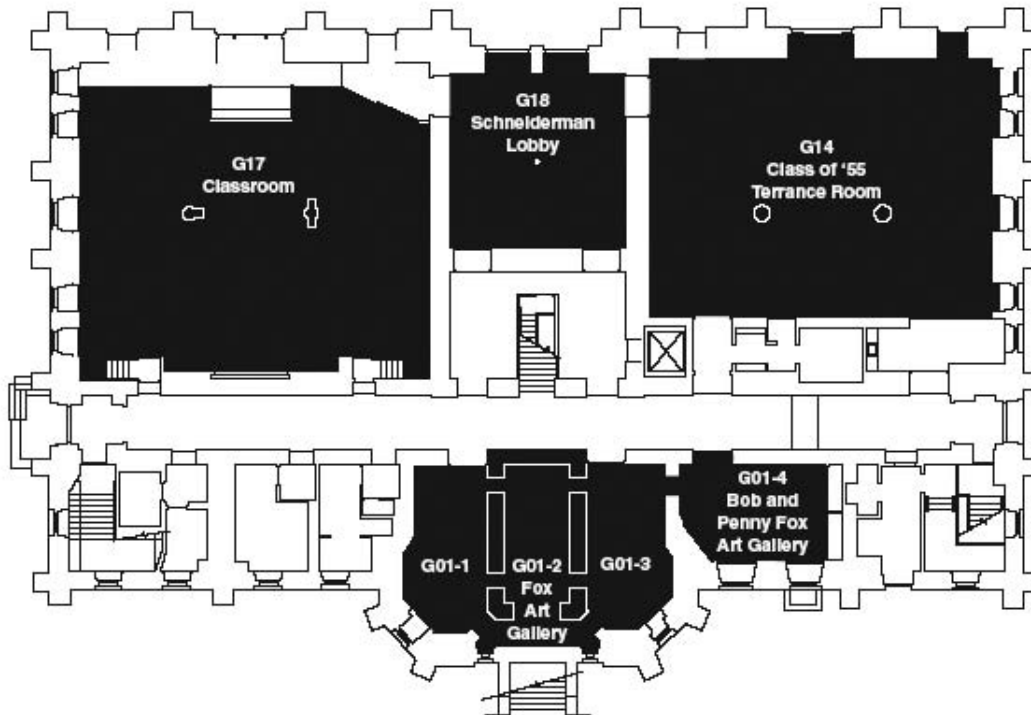
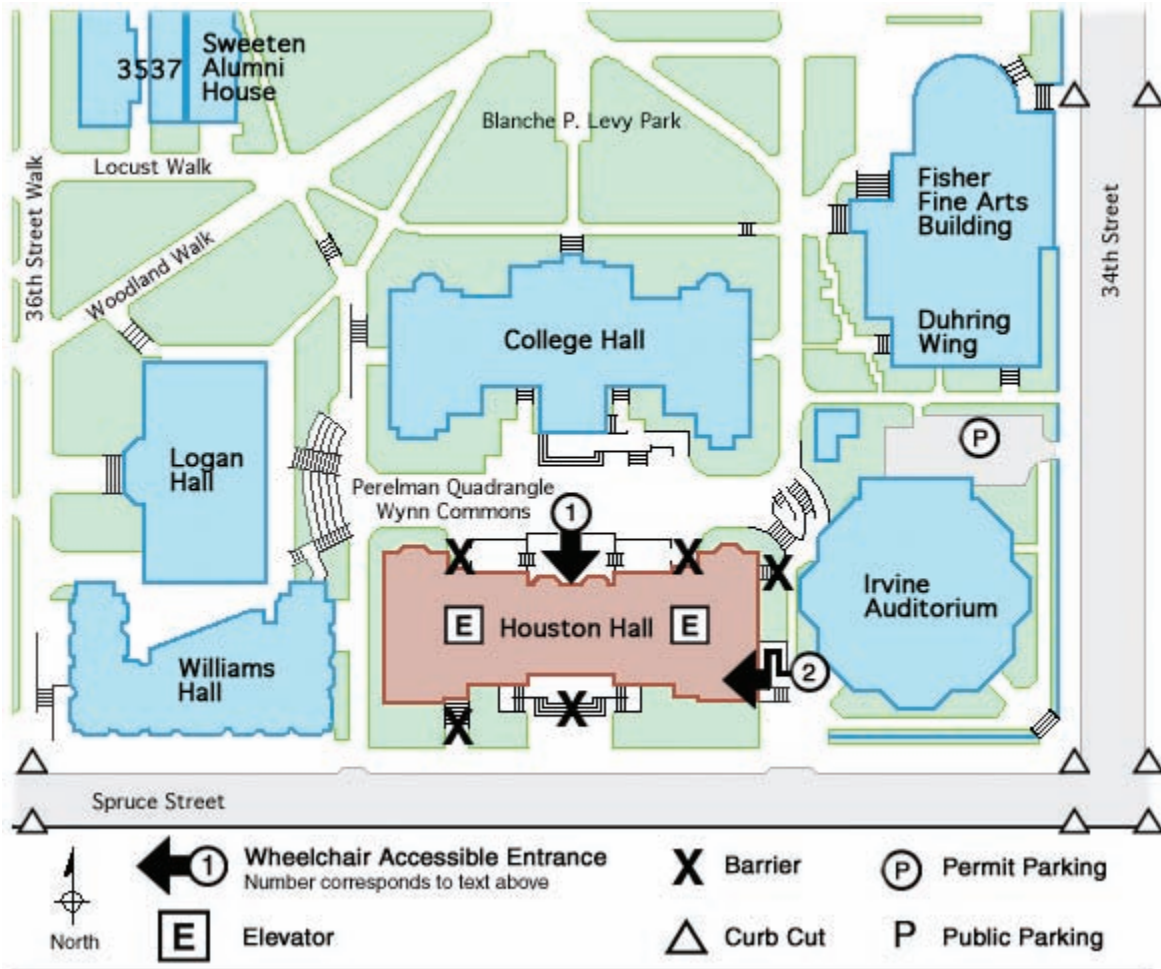

Logan Hall - Ground Floor

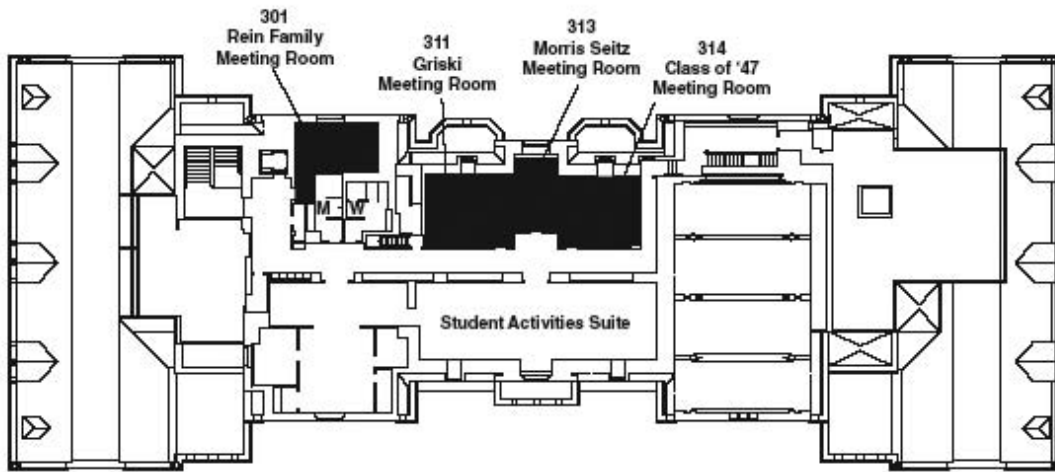

Houston Hall  
First Floor

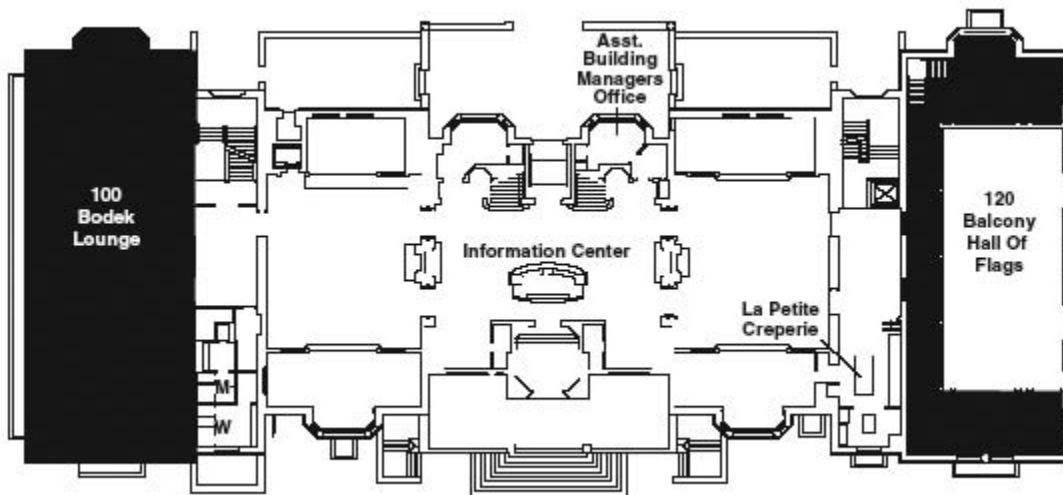

Houston Hall  
Third Floor

Irvine  
First Floor

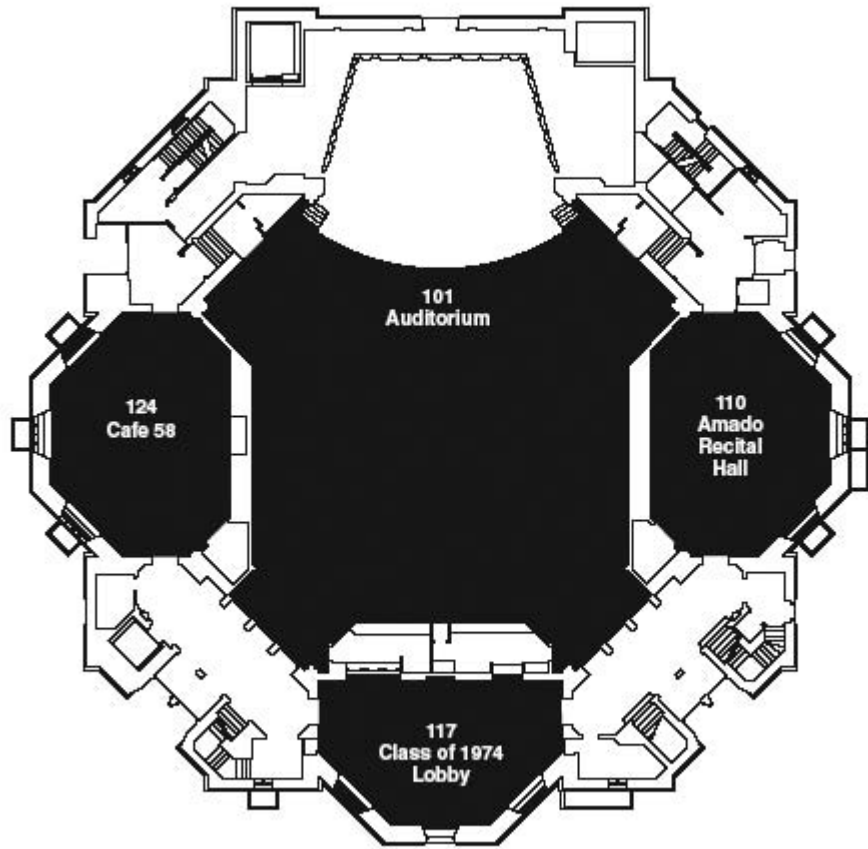

Irvine  
Ground Floor

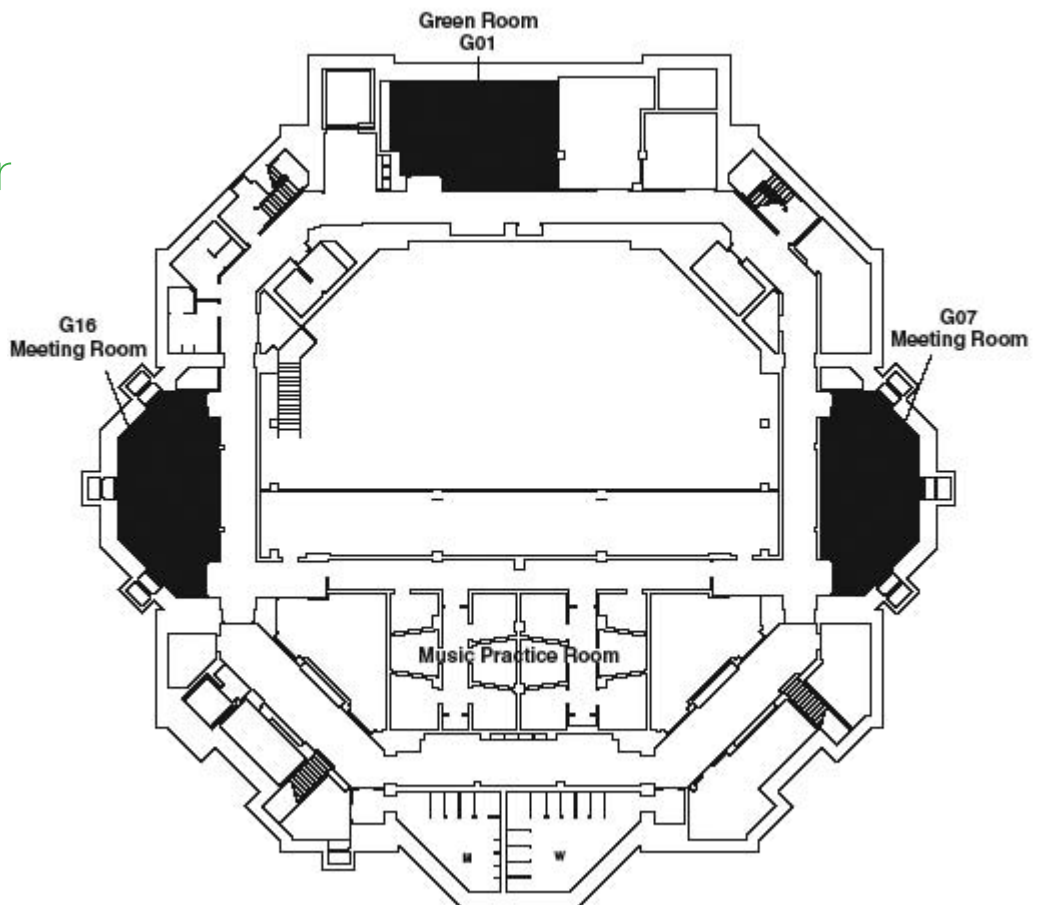

## About PAVNY Campus Compact & Learn and Serve

As part of a three-year Learn and Serve America grant, the Pennsylvania and New York Campus Compact consortium is supporting PHENND to in turn support area campuses to “institutionalize service-learning” on their campuses. Through a competitive, peer-reviewed RFP process, eight local higher eds were selected in December 2006 for projects that take place through August 2009. The institutions represent varying levels of service-learning programming from “beginner” to “advanced.” PHENND is providing modest grants, which are matched by each institution, to support infrastructure development. PHENND also provides training and technical assistance to grantees. Learn and Serve funding also supports the further development and refinement of the PHENND Network through activities such as the Annual Conference, Quarterly PHENND Meetings, and weekly PHENND Update.

Participating institutions are:

Bryn Mawr College

Cabrini College

Chestnut Hill College

Gwynedd-Mercy College

Montgomery County Community College

Saint Joseph’s University

University of Pennsylvania

Widener University



*Pennsylvania* | **Campus Compact**



## PHENND Institutions

Arcadia University  
Bryn Mawr College  
Bucks County Community College  
Cabrini College  
Chestnut Hill College  
Cheyney University  
Community College of Philadelphia  
Delaware Valley College  
Drexel University  
Eastern University  
Gwynedd-Mercy College  
Haverford College  
Holy Family University  
Immaculata University  
La Salle University  
Lincoln University  
Montgomery County Community College  
Neumann College  
Penn State Cooperative Extension  
Penn State Brandywine  
Penn State University - Great Valley Campus  
Philadelphia University  
Rosemont College  
Rutgers University-Camden  
St. Joseph's University  
Swarthmore College  
Temple University  
Temple University Ambler  
University of Pennsylvania  
University of the Sciences in Philadelphia  
Ursinus College  
Valley Forge Christian College  
Valley Forge Military Academy & College  
Villanova University  
West Chester University  
Widener University

## Acknowledgements

### **PHENND would like to thank the following individuals and organizations:**

Barbara and Edward Netter Center for Community Partnerships at the University of Pennsylvania  
Pennsylvania/New York Campus Compact Consortium and Learn and Serve America

## Conference Planning Committee

Dr. Arlene Dowshen <i>Coordinator Academic Service-Learning Faculty Development Program Widener University</i>	Albert Mosley <i>Associate Director Center for Civic Engagement Drexel University</i>
Dr. Charlene Gray <i>Executive Director Pennsylvania Campus Compact</i>	Dr. Marcine Pickron-Davis <i>Assistant to the President for Community Engagement and Diversity Initiatives Widener University</i>
Louise Giugliano <i>University Ministry and Service La Salle University</i>	Dr. Suzanne Rocheleau <i>Associate Dean Pennoni Honors College Drexel University</i>
Dr. Matt Hartley <i>Graduate School of Education University of Pennsylvania</i>	Joann Weeks <i>Netter Center for Community Partnerships University of Pennsylvania</i>
Karen Kaskey <i>Executive Director PennSERVE</i>	

The logo for PHENND features the word "PHENND" in a bold, blue, sans-serif font. The letters 'H', 'E', and 'N' are stylized to resemble buildings with windows. Below the text is a blue silhouette of a city skyline.

Philadelphia Higher Education Network for Neighborhood Development



